



Project Name

WEST WITNEY PRIMARY SCHOOL



Location

Witney



Contractor

Kier Construction



System Installed

Absorb-R SofTone Panels - 40mm

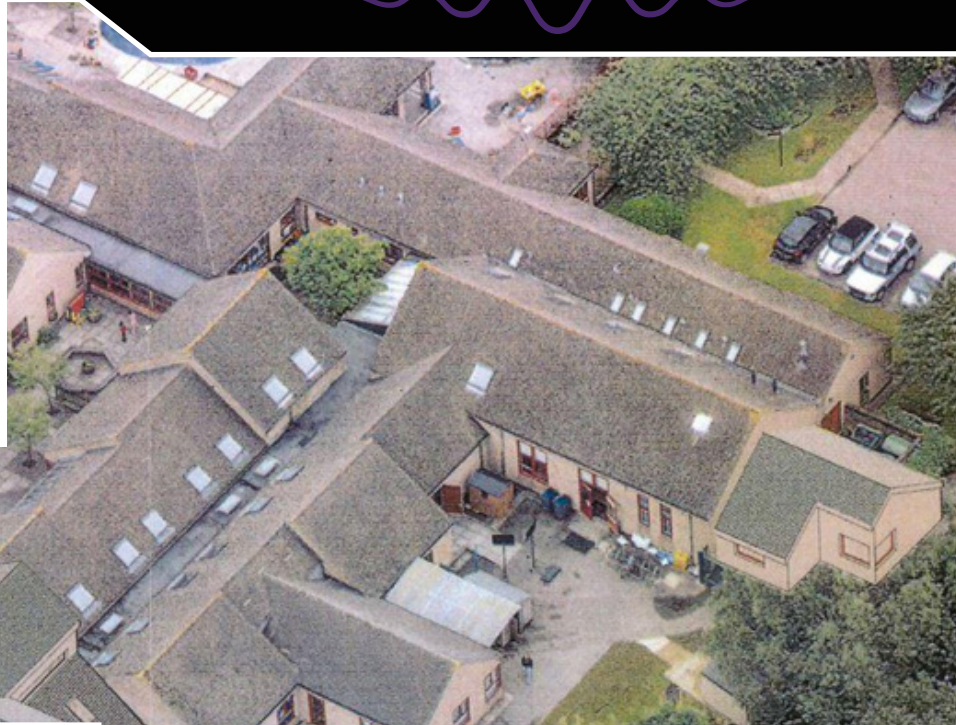

West Witney Primary School

West Witney Primary School underwent a two story extension to the back of the existing school to create four new classrooms along with their cloakrooms and toilets. In addition to this the school hall and kitchen will also be extended to accommodate the additional children.

PROJECT SCOPE

UK Acoustic Systems were contracted to supply & install an acoustic fabric wall mounted panelling system to the newly constructed classrooms to provide a brilliant working environment for students helping to control & reduce reverberation times (echos) enhancing the clarity of speech within the classrooms.

The system chosen on this project were the Soundis 40mm Absorb-R SofTone Panels which the client/ architect decided on a Camira Glass fabric to provide a subtle but modern aesthetic environment. Due to the panels being 40mm thick, they provide Class A acoustic performance which is the best classification of absorption that you can achieve.

[READ MORE ONLINE...](#)

